

REVISIONS				
REV	ECN #	DESCRIPTION	REV. BY/DATE	APR. BY
A	-----	REDRAWN & UPDATED IN SOLIDWORKS	02/1998	

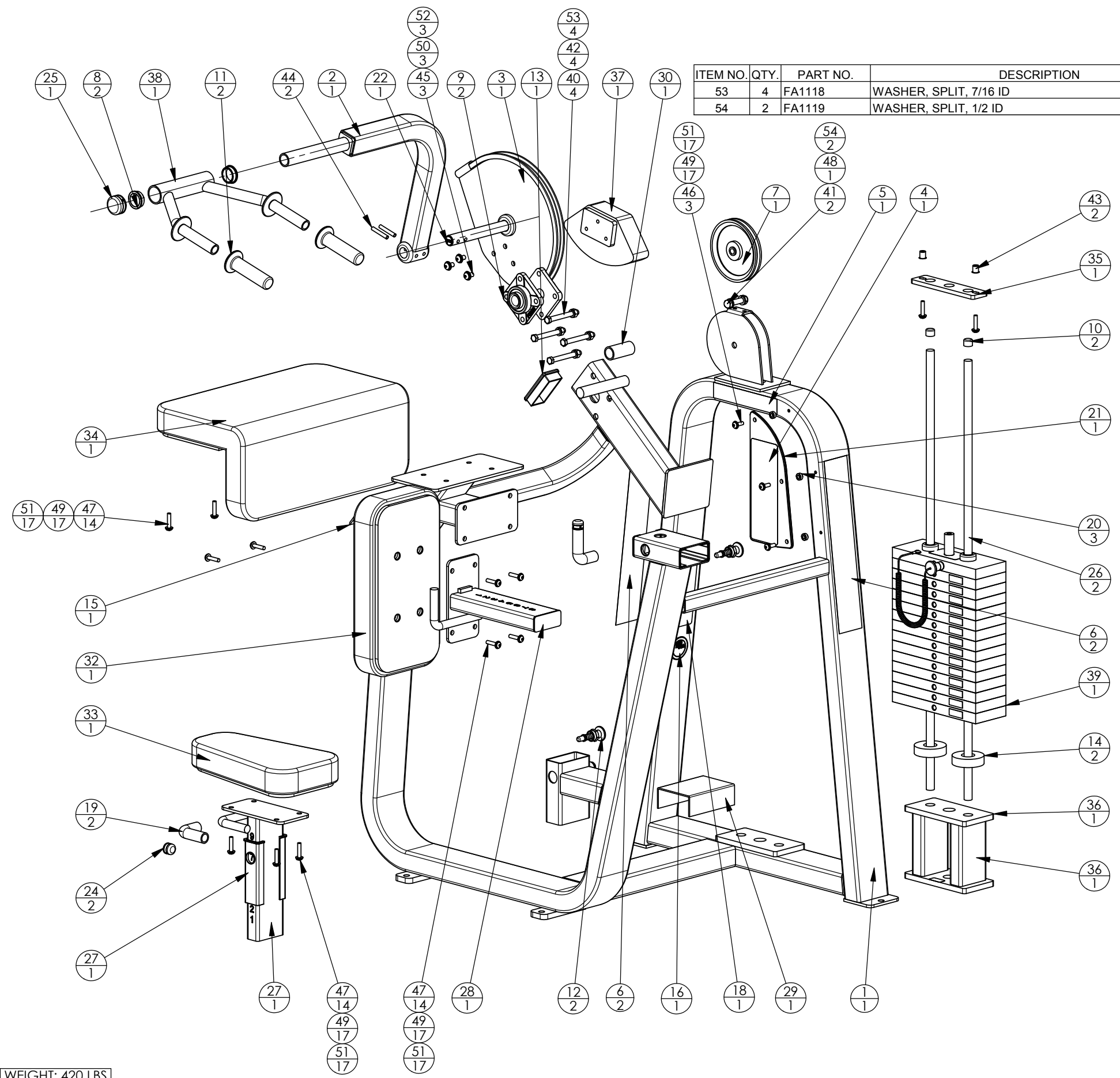

ITEM NO.	QTY.	PART NO.	DESCRIPTION
53	4	FA1118	WASHER, SPLIT, 7/16 ID
54	2	FA1119	WASHER, SPLIT, 1/2 ID

ITEM NO.	QTY.	PART NO.	DESCRIPTION
1	1	210-SA-1	210 MAIN FRAME ASSY
2	1	210-SA-3	210 ARM ASSY
3	1	210-SA-4	210 CAM ASSY
4	1	AC0210B	LABEL, INSTRUCTION, "TRICEP EXT FLAT 210"
5	1	AC1001	LABEL, "ICARIAN", 1 1/2 x 8 1/8
6	2	AC1002	LABEL, "ICARIAN", 3 1/2 x 21 1/2
7	1	AC1010	PULLEY, 6" DIA x 1/2" ID
8	2	AC1022	BUSHING, BRONZE, 1.270" ID x 1 1/2" OD
9	2	AC1025	PILLOW BLOCK FLANGE, 4 BOLT
10	2	AC1040	CAP, GUIDE ROD, DIA. 3/4
11	2	AC1042	GRIP, HANDLE, BMX SYLE
12	2	AC1051-MS	SNAP PIN, SMALL M-PULL
13	1	AC1057	CAP, BLACK PLASTIC, 2 x 4
14	2	AC1148	WEIGHT STACK BUMPER
15	1	AC1149	RUBBER BUMPER, 1 1/4 SQ.
16	1	AC1161	LABEL, ROUND, "MADE IN USA"
17	1	AC1164	LABEL, F.P.I. SERIAL NUMBER
18	1	AC1183	LABEL, "WARNING, SERIOUS INJURY..."
19	2	AC1225-6	RUBBERGRIP, DIA 3/4 x (5)
20	3	AC1228	SPACER, ALU, 21/64 ID x 5/8 OD x (1/4)
21	1	AC1230	INSTRUCTION PLACARD, 1/4" TEXTURED ABS PLASTIC
22	1	AC1232	LABEL, ROUND, "PIVOT"
23	4	AC1236-H	PLASTIC GLIDE WITH HOLE
24	2	AC220	HANDLE END CAP W/SET SCREWS, DIA 3/4"
25	1	AC221	SHAFT END CAP W/SET SCREWS, DIA 1 1/4"
26	2	CH1212	GUIDE ROD, 3/4 x 42 5/8 (#4)
27	1	CH4000	SEAT SUPPORT ASSY. 9 HOLE
28	1	CH4001	BACK/CHEST ADJ. 10", 8 POS.
29	1	CP1081	CUT PIECE, ABS CHANNEL, 1/8 x 2 x 4 1/4 x (6)
30	1	CP1182	CUT PIECE, VINYL HOSE, 1 1/4 OD x 1 ID x (2 3/4)
31	1	GH-210-51-875	CABLE ASSY, GH-210-51-875
32	1	PD1105	PAD, 9 x 17, 4 HOLES
33	1	PD1207	PAD, SEAT, 9 x 5 x (14 1/2), 4 HOLES
34	1	PD1210	PAD, ANGLED 2 PIECES, (7 1/2 x 22) (9 11/16 x 22)
35	1	PF1016	STEEL BAR FLAT CR/HR, 3/8 x 2 x (8 1/4)
36	1	SA1123	7" WEIGHT STACK RISER
37	1	SA1501	COUNTER WEIGHT ASSY. 2" THICK
38	1	SA1600	TRICEPT EXTENSION FLAT HANDLE
39	1	WS1500	WEIGHT STACK, 15 PLATE, 150 LBS.
40	4	FA1008	BOLT, HEX HEAD, BLK, 7/16-14 x 3 3/4
41	2	FA1035	NUT, HEX, ACORN, 1/2-13
42	4	FA1039	NUT, HEX, 7/16-14
43	2	FA1055	NUT, INSERT, 5/16-18
44	2	FA1065	PIN, SPRING, DIA. 5/16 x 2
45	3	FA1068	BOLT, BUTTON HEAD, 3/8-16 x 3/4
46	3	FA1071	BOLT, BUTTON HEAD, 5/16-18 x 1
47	14	FA1072	BOLT, BUTTON HEAD, 5/16-18 x 1 1/2
48	1	FA1101	STUD, 1/2-13 x 2 1/2
49	17	FA1106	WASHER, FLAT, 5/16 ID x 11/16 OD
50	3	FA1107	WASHER, FLAT, 3/8 ID x 13/16 OD
51	17	FA1116	WASHER, SPLIT, 5/16 ID
52	3	FA1117	WASHER, SPLIT, 3/8 ID

WEIGHT: 420 LBS.

UNLESS OTHERWISE SPECIFIED DIMENSIONS ARE IN INCHES		FITNESS PRODUCTS INTERNATIONAL ICARIAN FLITE ABENCH JADE STRETCH CENTER 12660 BRANFORD ST. SUN VALLEY, CA. 91352		TITLE TRICEP EXTENSION FLAT	SCALE 1:10
TOLERANCES ARE:					
FRACTIONS ± 1/32	DECIMALS .XX ± .01 .XXX ± .005	ANGLES ± 1°	DESIGNED BY TL	06/97	SHEET 1 OF 1
THIRD ANGLE PROJECTION			MODELED BY JCM	02/98	
DO NOT SCALE DRAWING			DRAWN BY RJB	04/00	
			APPROVED BY	SIZE B	DWG. NO. 210-EXP REV A

210 Tricep Extension Flat

Part Number	Description	Bubble Number
CW210SA1-212	ASSY,FRAME,MAIN,210,SKY WHITE	1.01
CW210SA1-222	ASSY,FRAME,MAIN,210,BLACK	1.02
CW210SA1-231	ASSY,FRAME,MAIN,210,RED	1.03
CW210SA1-241	ASSY,FRAME,MAIN,210,PLATINUM SPRKLE	1.04
CW210SA1-251	ASSY,FRAME,MAIN,210,SILVER	1.05
CW210SA1-261	ASSY,FRAME,MAIN,210,BLUE	1.06
CW210SA1-271	ASSY,FRAME,MAIN,210,CHARCOAL	1.07
CW210SA1-281	ASSY,FRAME,MAIN,210,CATHEDRAL GRAY	1.08
CW210SA1-291	ASSY,FRAME,MAIN,210,SILVER VIEN	1.09
CW210SA1-312	ASSY,FRAME,MAIN,210,STONE HG	1.11
CW210SA1-321	ASSY,FRAME,MAIN,210,TITANIUM HG	1.12
CW210SA1-322	ASSY,FRAME,MAIN,210,TITANIUM HG	1.12
CW210SA1-331	ASSY,FRAME,MAIN,210,WHITE GLOSS	1.13
CW210SA1-341	ASSY,FRAME,MAIN,210,BLACK ONYX	1.14
CW210SA1-352	ASSY,FRAME,MAIN,210,LIGHT BRONZE	1.15
CW210SA1-362	ASSY,FRAME,MAIN,210,SAPPHIRE BLUE	1.16
CW210SA3-311	ASSY, ARM, 210,STONE HG	2.11
CW210SA4-211	ASSY,CAM,210,SKY WHITE	3.01
CW210SA4-221	ASSY,CAM,210,BLACK	3.02
CW210SA4-231	ASSY,CAM,210,RED	3.03
CW210SA4-241	ASSY,CAM,210,PLATINUM SPRKLE	3.04
CW210SA4-251	ASSY,CAM,210,SILVER	3.05
CW210SA4-261	ASSY,CAM,210,BLUE	3.06
CW210SA4-271	ASSY,CAM,210,CHARCOAL	3.07
CW210SA4-281	ASSY,CAM,210,CATHEDRAL GRAY	3.08
CW210SA4-291	ASSY,CAM,210,SILVER VEIN	3.09
CW210SA4-311	ASSY,CAM,210,STONE HG	3.11
CW210SA4-321	ASSY,CAM,210,TITANIUM HG	3.12
CW210SA4-331	ASSY,CAM,210,WHITE GLOSS	3.13
CW210SA4-341	ASSY,CAM,210,BLACK ONYX	3.14
CW210SA4-351	ASSY,CAM,210,LIGHT BRONZE	3.15
CW210SA4-361	ASSY,CAM,210,SAPPHIRE BLUE	3.16
CWAC1010-101	PULLEY, 6 DIA X 1/2 ID	7
CW10043-135	BUSHING, BRONZE, 1 1/4" ID X 1 1/2"	8
CW12405-101	PILLOW BLOCK, BEARING, FLANGE, 4 BO	9
CW12404-101	CAP, GUIDE ROD,DIA 3/4, BLK	10
CWGR4204-500	GRIP,BMX, 1" DIA	11
CW30165-751	ASSY, POP PIN, 0.450 DIA HANDLE, B	12
CW11311-102	ENDCAP, REC TUBE, 2X4, BLK PLASTIC	13
CW12402-101	BUMPER, WEIGHT STACK, BLK RUBBER	14
CW12575-101	MOULDED BUMPON, BLACK, 31.75MM SQ (15
CWGR2505-000	GRIP,RUBBER,3/4" DIA, 5"	19
CWAC1228-901	SPACER, ALU,.328 ID X .625 OD X .25	20
CWAC1236-102	GUIDE INSERT, PLASTIC WITH HOLE, BL	21
CWAC220-901	HANDLE END CAP W/SET SCREWS, DIA 3/	24
CWAC221-901	SHAFT END CAP W/SET SCREWS, DIA 1 1	25
CWPF1212-711	GUIDE ROD, 3/4 X 42 5/8 (#4), CHM	26
CW32215-711	ASSEMBLY, SEAT ADJUSTMENT, 8 HOLE,	27
CWCP8106-000	CP, ABS CHANNEL, 1/8 X 2 X 4 X 6	29

CWGR2602-750	GRIP,RUBBER, 1" DIA, 2-3/4"	30
CWCLGH051-875	ASSY, CABLE, 210	31
CWPD1105B-101	PAD,9X17,4HOLES,W/BP,BLACK	32.01
CWPD1105B-103	PAD,9X17,4HOLES,W/BP,DVE GRY	32.03
CWPD1105B-105	PAD,9X17,4HOLES,W/BP,GROTTO	32.05
CWPD1105B-106	PAD,9X17,4HOLES,W/BP,GRAPHITE	32.06
CWPD1105B-107	PAD,9X17,4HOLES,W/BP,RED	32.07
CWPD1105B-108	PAD,9X17,4HOLES,W/BP,CHN GRN	32.08
CWPD1105B-109	PAD,9X17,4HOLES,W/BP,TURQSE	32.09
CWPD1105B-110	PAD,9X17,4HOLES,W/BP,RASP	32.1
CWPD1105B-111	PAD,9X17,4HOLES,W/BP,PLUM	32.11
CWPD1105B-112	PAD,9X17,4HOLES,W/BP,REGIMENT	32.12
CWPD1105B-113	PAD,9X17,4HOLES,W/BP,SPC BLUE	32.13
CWPD1105B-115	PAD,9X17,4HOLES,W/BP,BLK LTHR	32.15
CWPD1105B-116	PAD,9X17,4HOLES,W/BP,NVBL LTH	32.16
CWPD1105B-117	PAD,9X17,4HOLES,W/BP,PUTTY	32.17
CWPD1105B-118	PAD,9X17,4HOLES,W/BP,IMPRL BLUE	32.18
CWPD1105B-119	PAD,9X17,4HOLES,W/BP,YEW GREEN	32.19
CWPD1105B-120	PAD,9X17,4HOLES,W/BP,DUSTY JADE	32.2
CWPD1105B-121	PAD,9X17,4HOLES,W/BP,TERRA COTTA	32.21
CWPD1105B-122	PAD,9X17,4HOLES,W/BP,PAPRIKA	32.22
CWPD1105B-123	PAD,9X17,4HOLES,W/BP,ASH LTHR	32.23
CWPD1105B-124	PAD,9X17,4HOLES,W/BP,CERULEAN LTHR	32.24
CWPD1105B-125	PAD,9X17,4HOLES,W/BP,CHARCOAL LTHR	32.25
CWPD1105B-126	PAD,9X17,4HOLES,W/BP,HUNTER LTHR	32.26
CWPD1105B-127	PAD,9X17,4HOLES,W/BP,MOSS LTHR	32.27
CWPD1105B-128	PAD,9X17,4HOLES,W/BP,SPICE LTHR	32.28
CWPD1105B-129	PAD,9X17,4HOLES,W/BP,TOMATO LTHR	32.29
CWPD1207B-101	PAD,5X9X14.5,4HOLES,W/BP,BLACK	33.01
CWPD1207B-102	PAD,5X9X14.5,4HOLES,W/BP,RYL BL	33.02
CWPD1207B-103	PAD,5X9X14.5,4HOLES,W/BP,DVE GRY	33.03
CWPD1207B-104	PAD,5X9X14.5,4HOLES,W/BP,CROCUS	33.04
CWPD1207B-105	PAD,5X9X14.5,4HOLES,W/BP,GROTTO	33.05
CWPD1207B-106	PAD,5X9X14.5,4HOLES,W/BP,GRAPHITE	33.06
CWPD1207B-107	PAD,5X9X14.5,4HOLES,W/BP,RED	33.07
CWPD1207B-108	PAD,5X9X14.5,4HOLES,W/BP,CHN GRN	33.08
CWPD1207B-109	PAD,5X9X14.5,4HOLES,W/BP,TURQSE	33.09
CWPD1207B-110	PAD,5X9X14.5,4HOLES,W/BP,RASP	33.1
CWPD1207B-111	PAD,5X9X14.5,4HOLES,W/BP,PLUM	33.11
CWPD1207B-112	PAD,5X9X14.5,4HOLES,W/BP,REGIMENT	33.12
CWPD1207B-113	PAD,5X9X14.5,4HOLES,W/BP,SPC BLUE	33.13
CWPD1207B-115	PAD,5X9X14.5,4HOLES,W/BP,BLK LTHR	33.15
CWPD1207B-116	PAD,5X9X14.5,4HOLES,W/BP,NVBL LTH	33.16
CWPD1207B-117	PAD,5X9X14.5,4HOLES,W/BP,PUTTY	33.17
CWPD1207B-118	PAD,5X9X14.5,4HOLES,W/BP,IMPRL BL	33.18
CWPD1207B-119	PAD,5X9X14.5,4HOLES,W/BP,YEW GRN	33.19
CWPD1207B-120	PAD,5X9X14.5,4HOLES,W/BP,DSTY JD	33.2
CWPD1207B-121	PAD,5X9X14.5,4HOLES,W/BP,TER COT	33.21
CWPD1207B-122	PAD,5X9X14.5,4HOLES,W/BP,PAPRIKA	33.22
CWPD1207B-123	PAD,5X9X14.5,4HLS,W/BP,ASH LTHR	33.23
CWPD1207B-124	PAD,5X9X14.5,4HLS,W/BP,CERULAN LTHR	33.24

CWPD1207B-125	PAD,5X9X14.5,4HLS,W/BP,CHARCOAL LTH	33.25
CWPD1207B-126	PAD,5X9X14.5,4HLS,W/BP,HUNTER LTHR	33.26
CWPD1207B-127	PAD,5X9X14.5,4HLS,W/BP,MOSS LTHR	33.27
CWPD1207B-128	PAD,5X9X14.5,4HLS,W/BP,SPICE LTHR	33.28
CWPD1207B-129	PAD,5X9X14.5,4HLS,W/BP,TOMATO LTH	33.29
CWPD1210J-101	PAD,ANGL,2PC(7.5X22)(9.69X22),BLK,	34.01
CWPD1210J-102	PAD,ANGL,2PC(7.5X22)(9.69X22),RY BL	34.02
CWPD1210J-103	PAD,ANGL,2PC(7.5X22)(9.69X22),DV GR	34.03
CWPD1210J-104	PAD,ANGL,2PC(7.5X22)(9.69X22),CRCUS	34.04
CWPD1210J-105	PAD,ANGL,2PC(7.5X22)(9.69X22),GROTT	34.05
CWPD1210J-106	PAD,ANGL,2PC(7.5X22)(9.69X22),GRPHT	34.06
CWPD1210J-107	PAD,ANGL,2PC(7.5X22)(9.69X22),RED,	34.07
CWPD1210J-108	PAD,ANGL,2PC(7.5X22)(9.69X22),CHGR,	34.08
CWPD1210J-109	PAD,ANGL,2PC(7.5X22)(9.69X22),TRQS,	34.09
CWPD1210J-110	PAD,ANGL,2PC(7.5X22)(9.69X22),RASP,	34.1
CWPD1210J-111	PAD,ANGL,2PC(7.5X22)(9.69X22),PLUM,	34.11
CWPD1210J-112	PAD,ANGL,2PC(7.5X22)(9.69X22),RGMT,	34.12
CWPD1210J-113	PAD,ANGL,2PC(7.5X22)(9.69X22),SP BL	34.13
CWPD1210J-115	PAD,ANGL,2PC(7.5X22)(9.69X22)BLK LT	34.15
CWPD1210J-116	PAD,ANGL,2PC(7.5X22)(9.69X22)NBL LT	34.16
CWPD1210J-117	PAD,ANGL,2PC(7.5X22)(9.69X22),PUTTY	34.17
CWPD1210J-118	PD,ANGL,2PC(7.5X22)(9.69X22),IMP BL	34.18
CWPD1210J-119	PD,ANGL,2PC(7.5X22)(9.69X22),YW GRN	34.19
CWPD1210J-120	PD,ANGL,2PC(7.5X22)(9.69X22),DST JD	34.2
CWPD1210J-121	PD,ANGL,2PC(7.5X22)(9.69X22),TRA CT	34.21
CWPD1210J-122	PD,ANGL,2PC(7.5X22)(9.69X22),PAPRKA	34.22
CWPD1210J-123	PD,ANGL,2PC,7.5X22,9.69X22,ASH LTHR	34.23
CWPD1210J-124	PD,ANGL,2P,7.5X22,9.69X22,CERLN LTH	34.24
CWPD1210J-125	PD,ANGL,2P,7.5X22,9.69X22,CHRCL LTH	34.25
CWPD1210J-126	PD,ANGL,2PC,7.5X22,9.69X22,HNTR LTH	34.26
CWPD1210J-127	PD,ANGL,2PC,7.5X22,9.69X22,MOSS LTH	34.27
CWPD1210J-128	PD,ANGL,2PC,7.5X22,9.69X22,SPCE LTH	34.28
CWPD1210J-129	PD,ANGL,2PC,7.5X22,9.69X22,TMTO LTH	34.29
CWPF1016-731	BAR,,FLAT CR/HR, 3/8 X 2 X 8 1/4, 3	35
CWSA1123-721	ASSY,7" WEIGHT STACK RISER	36
CWSA1501-721	WELDMENT, COUNTER WEIGHT, 2" THK, W	37
CWSA1600-721	WELDMENT,TRICEP EXT FLAT HANDLE,WRK	38
CWHCYN044-375	SCREW, HEX HEAD , BLK XYL A	40
CWKADLN050-081	NUT, ACORN, 1/2-13	41
CWKMYN044-038	NUT, HEX, UNC, 7/16-14, BLK XYL AN	42
CW12537-109	NUT,INSERT,THIN-NUT,LARGE FLANGE	43
CWLDNN031-200	PIN, ROLL, DIA 5/16 X 2.00	44
CWTAYN038-075	SCREW, BUTTON HEAD, BLK XYL AN, 3/8	45
CWTAYN031-100	SCREW, BUTTON HEAD, BLK XYL AN, 5/1	46
CWTAYN031-150	SCREW, BUTTON HEAD, BLK XYL AN,5/16	47
CWBFNN050-250	STUD, 1/2-13 X 2 1/2	48
CWWBKN031-007	WASHER, FLAT, TYPE A, SAE, 5/16 ID	49
CWWBKN038-007	WASHER, FLAT, TYPE A, SAE, 3/8 ID	50
CWWALYN031-008	WASHER, SPLIT, 5/16 ID, BL	51
CWWALYN038-009	WASHER, SPLIT, 3/8 ID, BLK XYL AN	52
CWWALYN044-011	WASHER, SPLIT, 7/16 ID, BLK XYL AN	53

CWWALYN050-013	WASHER, SPLIT, 1/2 ID, BLK XYLAN	54
CW31756-101	LABEL, PRECOR USA ICARIAN LINE	55
CW31784-731	STOP PLUG, BLK ZN	56
CW30010-101	LABEL,WARNING STRENGTH	57
CW30138-101	ASSY, LABEL,INSTRUCTION,210	58
CWAC1232-101	LABEL, ROUND, "PIVOT"	60
CWAC1236-101	GUIDE INSERT, PLASTIC WITHOUT HOLE,	61
CW12634-101	SPRING, TORSION 90 DEG X 0.484 X 0.	72
CW31770-742	LATCH PIVOTING PIN, CLR ZN	73
CWAMNN028-003	RING, RETAINING, 2-TURN, SPIRAL, SS	74
CW12633-101	ENDCAP, REC TUBE, LDP, 1 1/2 X 3 1	75
CWAC220-901	HANDLE END CAP W/SET SCREWS, DIA 3/	101
CWGR2505-000	GRIP,RUBBER,3/4" DIA, 5"	102
CW10505-721	ASSY, PLATE, WEIGHT, 05 LBS, WRKL B	200
CW10510-721	ASSY, PLATE, WEIGHT, 10 LBS, WRKL B	201
CWAC1133-101	BUSHING, WEIGHT PLATE, LDPE PLASTIC	203
CW30172-751	ASSY, 4.00 IN WEIGHT STACK PIN AND	227
CWLDNN038-200	PIN, ROLL, DIA 3/8 X 2	250
CW30184-901	ASSY,BARREL, TOP PLATE,ALUMINUM	251
CW10535-722	PLATE, WEIGHT, SMALLTOP (STP-S), 0	281
CW10550-722	PLATE, WEIGHT, MED TOP (MTP-S), 10	283
CW30130-711	SELECTOR STEM, 15 PLATE,0 .875 DIA,	304
CW30011-101	LABEL,WARNING WEIGHT STACK	311
CW12401-102	LABEL, WEIGHT PLATE, 10 LBS/ 4.6 KG	315
CW12401-104	LABEL, WEIGHT PLATE, 15 LBS/ 6.8 KG	317
CW12401-106	LABEL, WEIGHT PLATE, 20 LBS/ 8 KG	319
CW12401-108	LABEL, WEIGHT PLATE, 25 LBS/ 11.4 K	321
CW12401-110	LABEL, WEIGHT PLATE, 30 LBS/ 13.6 K	323
CW12401-112	LABEL, WEIGHT PLATE, 35 LBS/ 15.9 K	325
CW12401-114	LABEL, WEIGHT PLATE, 40 LBS/ 18.2 K	327
CW12401-116	LABEL, WEIGHT PLATE, 45 LBS/ 20.5 K	329
CW12401-118	LABEL, WEIGHT PLATE, 50 LBS/ 22.7 K	331
CW12401-119	LABEL, WEIGHT PLATE, 55 LBS/ 25 KG	332
CW12401-120	LABEL, WEIGHT PLATE, 60 LBS/ 27.3 K	332
CW12401-120	LABEL, WEIGHT PLATE, 60 LBS/ 27.3 K	333
CW12401-121	LABEL, WEIGHT PLATE, 65 LBS/ 29.5 K	334
CW12401-122	LABEL, WEIGHT PLATE, 70 LBS/ 31.8 K	335
CW12401-123	LABEL, WEIGHT PLATE, 75 LBS/ 34.1 K	336
CW12401-124	LABEL, WEIGHT PLATE, 80 LBS/ 36.4 K	337
CW12401-126	LABEL, WEIGHT PLATE, 90 LBS/ 40.9 K	339
CW12401-128	LABEL, WEIGHT PLATE, 100 LBS/ 45.5	341
CW12401-129	LABEL, WEIGHT PLATE, 110 LBS/ 50 KG	342
CW12401-130	LABEL, WEIGHT PLATE, 120 LBS/ 54.6	343
CW12401-131	LABEL, WEIGHT PLATE, 130 LBS/ 59.1	344
CW12401-132	LABEL, WEIGHT PLATE, 140 LBS/ 63.6	345
CW12401-133	LABEL, WEIGHT PLATE, 150 LBS/ 68.2	346
CW12537-109	NUT,INSERT,THIN-NUT,LARGE FLANGE	400
CW30126-101	LABEL,VINYL, PRECOR, 3.25 X 18.0	401
CWPF3143-211	SHROUD,SHEET,STEEL,3/32 THICK,4 BEN	402.01
CWPF3143-221	SHROUD,SHEET,STEEL,3/32 THICK,4 BEN	402.02
CWPF3143-231	SHROUD,SHEET,STEEL,3/32 THICK,4 BEN	402.03

CWPF3143-241	SHROUD,SHEET,STEEL,3/32 THICK,4 BEN	402.04
CWPF3143-251	SHROUD,SHEET,STEEL,3/32 THICK,4 BEN	402.05
CWPF3143-261	SHROUD,SHEET,STEEL,3/32 THICK,4 BEN	402.06
CWPF3143-271	SHROUD,SHEET,STEEL,3/32 THICK,4 BEN	402.07
CWPF3143-281	SHROUD,SHEET,STEEL,3/32 THICK,4 BEN	402.08
CWPF3143-291	SHROUD,SHEET,STEEL,3/32 THICK,4 BEN	402.09
CWPF3143-311	SHROUD,SHEET,STEEL,3/32 THICK,4 BEN	402.11
CWPF3143-321	SHROUD,SHEET,STEEL,3/32 THICK,4 BEN	402.12
CWPF3143-331	SHROUD,SHEET,STEEL,3/32 THICK,4 BEN	402.13
CWPF3143-341	SHROUD,SHEET,STEEL,3/32 THICK,4 BEN	402.14
CWPF3143-351	SHROUD,SHEET,STEEL,3/32 THICK,4 BEN	402.15
CWPF3143-361	SHROUD,SHEET,STEEL,3/32 THICK,4 BEN	402.16
CWPF3143-711	SHROUD,SHEET,STEEL,3/32 THICK,4 BEN	402.17
CWPF3144-721	SHROUD BRKT,PLATE,STEEL,1/8 THICK,1	403
CWPF3145-721	SHROUD BRKT,PLATE,STEEL,1/8 THICK,2	404
CWTAYN031-100	SCREW, BUTTON HEAD, BLK XYLAN, 5/1	405
CWWALYN031-008	WASHER, SPLIT, 5/16 ID, BL	406
CWWBKN031-007	WASHER, FLAT, TYPE A, SAE, 5/16 ID	407
CWAC1177-101	FLOOR PROTECTOR, RUBBER, 4.563 X 4.	501
CWAC1178-101	FLOOR PROTECTOR, RUBBER, 2.563 X 6.	502

Your Price

210 Tricep Extension Flat

Part Number	Description	Bubble Number
CW210SA1-212	ASSY,FRAME,MAIN,210,SKY WHITE	1.01
CW210SA1-222	ASSY,FRAME,MAIN,210,BLACK	1.02
CW210SA1-231	ASSY,FRAME,MAIN,210,RED	1.03
CW210SA1-241	ASSY,FRAME,MAIN,210,PLATINUM SPRKLE	1.04
CW210SA1-251	ASSY,FRAME,MAIN,210,SILVER	1.05
CW210SA1-261	ASSY,FRAME,MAIN,210,BLUE	1.06
CW210SA1-271	ASSY,FRAME,MAIN,210,CHARCOAL	1.07
CW210SA1-281	ASSY,FRAME,MAIN,210,CATHEDRAL GRAY	1.08
CW210SA1-291	ASSY,FRAME,MAIN,210,SILVER VIEN	1.09
CW210SA1-312	ASSY,FRAME,MAIN,210,STONE HG	1.11
CW210SA1-321	ASSY,FRAME,MAIN,210,TITANIUM HG	1.12
CW210SA1-322	ASSY,FRAME,MAIN,210,TITANIUM HG	1.12
CW210SA1-331	ASSY,FRAME,MAIN,210,WHITE GLOSS	1.13
CW210SA1-341	ASSY,FRAME,MAIN,210,BLACK ONYX	1.14
CW210SA1-352	ASSY,FRAME,MAIN,210,LIGHT BRONZE	1.15
CW210SA1-362	ASSY,FRAME,MAIN,210,SAPPHIRE BLUE	1.16
CW210SA3-311	ASSY, ARM, 210,STONE HG	2.11
CW210SA4-211	ASSY,CAM,210,SKY WHITE	3.01
CW210SA4-221	ASSY,CAM,210,BLACK	3.02
CW210SA4-231	ASSY,CAM,210,RED	3.03
CW210SA4-241	ASSY,CAM,210,PLATINUM SPRKLE	3.04
CW210SA4-251	ASSY,CAM,210,SILVER	3.05
CW210SA4-261	ASSY,CAM,210,BLUE	3.06
CW210SA4-271	ASSY,CAM,210,CHARCOAL	3.07
CW210SA4-281	ASSY,CAM,210,CATHEDRAL GRAY	3.08
CW210SA4-291	ASSY,CAM,210,SILVER VEIN	3.09
CW210SA4-311	ASSY,CAM,210,STONE HG	3.11
CW210SA4-321	ASSY,CAM,210,TITANIUM HG	3.12
CW210SA4-331	ASSY,CAM,210,WHITE GLOSS	3.13
CW210SA4-341	ASSY,CAM,210,BLACK ONYX	3.14
CW210SA4-351	ASSY,CAM,210,LIGHT BRONZE	3.15
CW210SA4-361	ASSY,CAM,210,SAPPHIRE BLUE	3.16
CWAC1010-101	PULLEY, 6 DIA X 1/2 ID	7
CW10043-135	BUSHING, BRONZE, 1 1/4" ID X 1 1/2"	8
CW12405-101	PILLOW BLOCK, BEARING, FLANGE, 4 BO	9
CW12404-101	CAP, GUIDE ROD,DIA 3/4, BLK	10
CWGR4204-500	GRIP,BMX, 1" DIA	11
CW30165-751	ASSY, POP PIN, 0.450 DIA HANDLE, B	12
CW11311-102	ENDCAP, REC TUBE, 2X4, BLK PLASTIC	13
CW12402-101	BUMPER, WEIGHT STACK, BLK RUBBER	14
CW12575-101	MOULDED BUMPON, BLACK, 31.75MM SQ (15
CWGR2505-000	GRIP,RUBBER,3/4" DIA, 5"	19
CWAC1228-901	SPACER, ALU,.328 ID X .625 OD X .25	20
CWAC1236-102	GUIDE INSERT, PLASTIC WITH HOLE, BL	21
CWAC220-901	HANDLE END CAP W/SET SCREWS, DIA 3/	24
CWAC221-901	SHAFT END CAP W/SET SCREWS, DIA 1 1	25
CWPF1212-711	GUIDE ROD, 3/4 X 42 5/8 (#4), CHM	26
CW32215-711	ASSEMBLY, SEAT ADJUSTMENT, 8 HOLE,	27
CWCP8106-000	CP, ABS CHANNEL, 1/8 X 2 X 4 X 6	29

CWGR2602-750	GRIP,RUBBER, 1" DIA, 2-3/4"	30
CWCLGH051-875	ASSY, CABLE, 210	31
CWPD1105B-101	PAD,9X17,4HOLES,W/BP,BLACK	32.01
CWPD1105B-103	PAD,9X17,4HOLES,W/BP,DVE GRY	32.03
CWPD1105B-105	PAD,9X17,4HOLES,W/BP,GROTTO	32.05
CWPD1105B-106	PAD,9X17,4HOLES,W/BP,GRAPHITE	32.06
CWPD1105B-107	PAD,9X17,4HOLES,W/BP,RED	32.07
CWPD1105B-108	PAD,9X17,4HOLES,W/BP,CHN GRN	32.08
CWPD1105B-109	PAD,9X17,4HOLES,W/BP,TURQSE	32.09
CWPD1105B-110	PAD,9X17,4HOLES,W/BP,RASP	32.1
CWPD1105B-111	PAD,9X17,4HOLES,W/BP,PLUM	32.11
CWPD1105B-112	PAD,9X17,4HOLES,W/BP,REGIMENT	32.12
CWPD1105B-113	PAD,9X17,4HOLES,W/BP,SPC BLUE	32.13
CWPD1105B-115	PAD,9X17,4HOLES,W/BP,BLK LTHR	32.15
CWPD1105B-116	PAD,9X17,4HOLES,W/BP,NVBL LTH	32.16
CWPD1105B-117	PAD,9X17,4HOLES,W/BP,PUTTY	32.17
CWPD1105B-118	PAD,9X17,4HOLES,W/BP,IMPRL BLUE	32.18
CWPD1105B-119	PAD,9X17,4HOLES,W/BP,YEW GREEN	32.19
CWPD1105B-120	PAD,9X17,4HOLES,W/BP,DUSTY JADE	32.2
CWPD1105B-121	PAD,9X17,4HOLES,W/BP,TERRA COTTA	32.21
CWPD1105B-122	PAD,9X17,4HOLES,W/BP,PAPRIKA	32.22
CWPD1105B-123	PAD,9X17,4HOLES,W/BP,ASH LTHR	32.23
CWPD1105B-124	PAD,9X17,4HOLES,W/BP,CERULEAN LTHR	32.24
CWPD1105B-125	PAD,9X17,4HOLES,W/BP,CHARCOAL LTHR	32.25
CWPD1105B-126	PAD,9X17,4HOLES,W/BP,HUNTER LTHR	32.26
CWPD1105B-127	PAD,9X17,4HOLES,W/BP,MOSS LTHR	32.27
CWPD1105B-128	PAD,9X17,4HOLES,W/BP,SPICE LTHR	32.28
CWPD1105B-129	PAD,9X17,4HOLES,W/BP,TOMATO LTHR	32.29
CWPD1207B-101	PAD,5X9X14.5,4HOLES,W/BP,BLACK	33.01
CWPD1207B-102	PAD,5X9X14.5,4HOLES,W/BP,RYL BL	33.02
CWPD1207B-103	PAD,5X9X14.5,4HOLES,W/BP,DVE GRY	33.03
CWPD1207B-104	PAD,5X9X14.5,4HOLES,W/BP,CROCUS	33.04
CWPD1207B-105	PAD,5X9X14.5,4HOLES,W/BP,GROTTO	33.05
CWPD1207B-106	PAD,5X9X14.5,4HOLES,W/BP,GRAPHITE	33.06
CWPD1207B-107	PAD,5X9X14.5,4HOLES,W/BP,RED	33.07
CWPD1207B-108	PAD,5X9X14.5,4HOLES,W/BP,CHN GRN	33.08
CWPD1207B-109	PAD,5X9X14.5,4HOLES,W/BP,TURQSE	33.09
CWPD1207B-110	PAD,5X9X14.5,4HOLES,W/BP,RASP	33.1
CWPD1207B-111	PAD,5X9X14.5,4HOLES,W/BP,PLUM	33.11
CWPD1207B-112	PAD,5X9X14.5,4HOLES,W/BP,REGIMENT	33.12
CWPD1207B-113	PAD,5X9X14.5,4HOLES,W/BP,SPC BLUE	33.13
CWPD1207B-115	PAD,5X9X14.5,4HOLES,W/BP,BLK LTHR	33.15
CWPD1207B-116	PAD,5X9X14.5,4HOLES,W/BP,NVBL LTH	33.16
CWPD1207B-117	PAD,5X9X14.5,4HOLES,W/BP,PUTTY	33.17
CWPD1207B-118	PAD,5X9X14.5,4HOLES,W/BP,IMPRL BL	33.18
CWPD1207B-119	PAD,5X9X14.5,4HOLES,W/BP,YEW GRN	33.19
CWPD1207B-120	PAD,5X9X14.5,4HOLES,W/BP,DSTY JD	33.2
CWPD1207B-121	PAD,5X9X14.5,4HOLES,W/BP,TER COT	33.21
CWPD1207B-122	PAD,5X9X14.5,4HOLES,W/BP,PAPRIKA	33.22
CWPD1207B-123	PAD,5X9X14.5,4HLS,W/BP,ASH LTHR	33.23
CWPD1207B-124	PAD,5X9X14.5,4HLS,W/BP,CERULAN LTHR	33.24

CWPD1207B-125	PAD,5X9X14.5,4HLS,W/BP,CHARCOAL LTH	33.25
CWPD1207B-126	PAD,5X9X14.5,4HLS,W/BP,HUNTER LTHR	33.26
CWPD1207B-127	PAD,5X9X14.5,4HLS,W/BP,MOSS LTHR	33.27
CWPD1207B-128	PAD,5X9X14.5,4HLS,W/BP,SPICE LTHR	33.28
CWPD1207B-129	PAD,5X9X14.5,4HLS,W/BP,TOMATO LTH	33.29
CWPD1210J-101	PAD,ANGL,2PC(7.5X22)(9.69X22),BLK,	34.01
CWPD1210J-102	PAD,ANGL,2PC(7.5X22)(9.69X22),RY BL	34.02
CWPD1210J-103	PAD,ANGL,2PC(7.5X22)(9.69X22),DV GR	34.03
CWPD1210J-104	PAD,ANGL,2PC(7.5X22)(9.69X22),CRCUS	34.04
CWPD1210J-105	PAD,ANGL,2PC(7.5X22)(9.69X22),GROTT	34.05
CWPD1210J-106	PAD,ANGL,2PC(7.5X22)(9.69X22),GRPHT	34.06
CWPD1210J-107	PAD,ANGL,2PC(7.5X22)(9.69X22),RED,	34.07
CWPD1210J-108	PAD,ANGL,2PC(7.5X22)(9.69X22),CHGR,	34.08
CWPD1210J-109	PAD,ANGL,2PC(7.5X22)(9.69X22),TRQS,	34.09
CWPD1210J-110	PAD,ANGL,2PC(7.5X22)(9.69X22),RASP,	34.1
CWPD1210J-111	PAD,ANGL,2PC(7.5X22)(9.69X22),PLUM,	34.11
CWPD1210J-112	PAD,ANGL,2PC(7.5X22)(9.69X22),RGMT,	34.12
CWPD1210J-113	PAD,ANGL,2PC(7.5X22)(9.69X22),SP BL	34.13
CWPD1210J-115	PAD,ANGL,2PC(7.5X22)(9.69X22)BLK LT	34.15
CWPD1210J-116	PAD,ANGL,2PC(7.5X22)(9.69X22)NBL LT	34.16
CWPD1210J-117	PAD,ANGL,2PC(7.5X22)(9.69X22),PUTTY	34.17
CWPD1210J-118	PD,ANGL,2PC(7.5X22)(9.69X22),IMP BL	34.18
CWPD1210J-119	PD,ANGL,2PC(7.5X22)(9.69X22),YW GRN	34.19
CWPD1210J-120	PD,ANGL,2PC(7.5X22)(9.69X22),DST JD	34.2
CWPD1210J-121	PD,ANGL,2PC(7.5X22)(9.69X22),TRA CT	34.21
CWPD1210J-122	PD,ANGL,2PC(7.5X22)(9.69X22),PAPRKA	34.22
CWPD1210J-123	PD,ANGL,2PC,7.5X22,9.69X22,ASH LTHR	34.23
CWPD1210J-124	PD,ANGL,2P,7.5X22,9.69X22,CERLN LTH	34.24
CWPD1210J-125	PD,ANGL,2P,7.5X22,9.69X22,CHRCL LTH	34.25
CWPD1210J-126	PD,ANGL,2PC,7.5X22,9.69X22,HNTR LTH	34.26
CWPD1210J-127	PD,ANGL,2PC,7.5X22,9.69X22,MOSS LTH	34.27
CWPD1210J-128	PD,ANGL,2PC,7.5X22,9.69X22,SPCE LTH	34.28
CWPD1210J-129	PD,ANGL,2PC,7.5X22,9.69X22,TMTO LTH	34.29
CWPF1016-731	BAR,,FLAT CR/HR, 3/8 X 2 X 8 1/4, 3	35
CWSA1123-721	ASSY,7" WEIGHT STACK RISER	36
CWSA1501-721	WELDMENT, COUNTER WEIGHT, 2" THK, W	37
CWSA1600-721	WELDMENT,TRICEP EXT FLAT HANDLE,WRK	38
CWHCYN044-375	SCREW, HEX HEAD , BLK XYL A	40
CWKADLN050-081	NUT, ACORN, 1/2-13	41
CWKMYN044-038	NUT, HEX, UNC, 7/16-14, BLK XYL AN	42
CW12537-109	NUT,INSERT,THIN-NUT,LARGE FLANGE	43
CWLDNN031-200	PIN, ROLL, DIA 5/16 X 2.00	44
CWTAYN038-075	SCREW, BUTTON HEAD, BLK XYL AN, 3/8	45
CWTAYN031-100	SCREW, BUTTON HEAD, BLK XYL AN, 5/1	46
CWTAYN031-150	SCREW, BUTTON HEAD, BLK XYL AN,5/16	47
CWBFNN050-250	STUD, 1/2-13 X 2 1/2	48
CWWBKN031-007	WASHER, FLAT, TYPE A, SAE, 5/16 ID	49
CWWBKN038-007	WASHER, FLAT, TYPE A, SAE, 3/8 ID	50
CWWALYN031-008	WASHER, SPLIT, 5/16 ID, BL	51
CWWALYN038-009	WASHER, SPLIT, 3/8 ID, BLK XYL AN	52
CWWALYN044-011	WASHER, SPLIT, 7/16 ID, BLK XYL AN	53

CWWALYN050-013	WASHER, SPLIT, 1/2 ID, BLK XYLAN	54
CW31756-101	LABEL, PRECOR USA ICARIAN LINE	55
CW31784-731	STOP PLUG, BLK ZN	56
CW30010-101	LABEL,WARNING STRENGTH	57
CW30138-101	ASSY, LABEL,INSTRUCTION,210	58
CWAC1232-101	LABEL, ROUND, "PIVOT"	60
CWAC1236-101	GUIDE INSERT, PLASTIC WITHOUT HOLE,	61
CW12634-101	SPRING, TORSION 90 DEG X 0.484 X 0.	72
CW31770-742	LATCH PIVOTING PIN, CLR ZN	73
CWAMNN028-003	RING, RETAINING, 2-TURN, SPIRAL, SS	74
CW12633-101	ENDCAP, REC TUBE, LDP, 1 1/2 X 3 1	75
CWAC220-901	HANDLE END CAP W/SET SCREWS, DIA 3/	101
CWGR2505-000	GRIP,RUBBER,3/4" DIA, 5"	102
CW10505-721	ASSY, PLATE, WEIGHT, 05 LBS, WRKL B	200
CW10510-721	ASSY, PLATE, WEIGHT, 10 LBS, WRKL B	201
CWAC1133-101	BUSHING, WEIGHT PLATE, LDPE PLASTIC	203
CW30172-751	ASSY, 4.00 IN WEIGHT STACK PIN AND	227
CWLDNN038-200	PIN, ROLL, DIA 3/8 X 2	250
CW30184-901	ASSY,BARREL, TOP PLATE,ALUMINUM	251
CW10535-722	PLATE, WEIGHT, SMALLTOP (STP-S), 0	281
CW10550-722	PLATE, WEIGHT, MED TOP (MTP-S), 10	283
CW30130-711	SELECTOR STEM, 15 PLATE,0 .875 DIA,	304
CW30011-101	LABEL,WARNING WEIGHT STACK	311
CW12401-102	LABEL, WEIGHT PLATE, 10 LBS/ 4.6 KG	315
CW12401-104	LABEL, WEIGHT PLATE, 15 LBS/ 6.8 KG	317
CW12401-106	LABEL, WEIGHT PLATE, 20 LBS/ 8 KG	319
CW12401-108	LABEL, WEIGHT PLATE, 25 LBS/ 11.4 K	321
CW12401-110	LABEL, WEIGHT PLATE, 30 LBS/ 13.6 K	323
CW12401-112	LABEL, WEIGHT PLATE, 35 LBS/ 15.9 K	325
CW12401-114	LABEL, WEIGHT PLATE, 40 LBS/ 18.2 K	327
CW12401-116	LABEL, WEIGHT PLATE, 45 LBS/ 20.5 K	329
CW12401-118	LABEL, WEIGHT PLATE, 50 LBS/ 22.7 K	331
CW12401-119	LABEL, WEIGHT PLATE, 55 LBS/ 25 KG	332
CW12401-120	LABEL, WEIGHT PLATE, 60 LBS/ 27.3 K	332
CW12401-120	LABEL, WEIGHT PLATE, 60 LBS/ 27.3 K	333
CW12401-121	LABEL, WEIGHT PLATE, 65 LBS/ 29.5 K	334
CW12401-122	LABEL, WEIGHT PLATE, 70 LBS/ 31.8 K	335
CW12401-123	LABEL, WEIGHT PLATE, 75 LBS/ 34.1 K	336
CW12401-124	LABEL, WEIGHT PLATE, 80 LBS/ 36.4 K	337
CW12401-126	LABEL, WEIGHT PLATE, 90 LBS/ 40.9 K	339
CW12401-128	LABEL, WEIGHT PLATE, 100 LBS/ 45.5	341
CW12401-129	LABEL, WEIGHT PLATE, 110 LBS/ 50 KG	342
CW12401-130	LABEL, WEIGHT PLATE, 120 LBS/ 54.6	343
CW12401-131	LABEL, WEIGHT PLATE, 130 LBS/ 59.1	344
CW12401-132	LABEL, WEIGHT PLATE, 140 LBS/ 63.6	345
CW12401-133	LABEL, WEIGHT PLATE, 150 LBS/ 68.2	346
CW12537-109	NUT,INSERT,THIN-NUT,LARGE FLANGE	400
CW30126-101	LABEL,VINYL, PRECOR, 3.25 X 18.0	401
CWPF3143-211	SHROUD,SHEET,STEEL,3/32 THICK,4 BEN	402.01
CWPF3143-221	SHROUD,SHEET,STEEL,3/32 THICK,4 BEN	402.02
CWPF3143-231	SHROUD,SHEET,STEEL,3/32 THICK,4 BEN	402.03

CWPF3143-241	SHROUD,SHEET,STEEL,3/32 THICK,4 BEN	402.04
CWPF3143-251	SHROUD,SHEET,STEEL,3/32 THICK,4 BEN	402.05
CWPF3143-261	SHROUD,SHEET,STEEL,3/32 THICK,4 BEN	402.06
CWPF3143-271	SHROUD,SHEET,STEEL,3/32 THICK,4 BEN	402.07
CWPF3143-281	SHROUD,SHEET,STEEL,3/32 THICK,4 BEN	402.08
CWPF3143-291	SHROUD,SHEET,STEEL,3/32 THICK,4 BEN	402.09
CWPF3143-311	SHROUD,SHEET,STEEL,3/32 THICK,4 BEN	402.11
CWPF3143-321	SHROUD,SHEET,STEEL,3/32 THICK,4 BEN	402.12
CWPF3143-331	SHROUD,SHEET,STEEL,3/32 THICK,4 BEN	402.13
CWPF3143-341	SHROUD,SHEET,STEEL,3/32 THICK,4 BEN	402.14
CWPF3143-351	SHROUD,SHEET,STEEL,3/32 THICK,4 BEN	402.15
CWPF3143-361	SHROUD,SHEET,STEEL,3/32 THICK,4 BEN	402.16
CWPF3143-711	SHROUD,SHEET,STEEL,3/32 THICK,4 BEN	402.17
CWPF3144-721	SHROUD BRKT,PLATE,STEEL,1/8 THICK,1	403
CWPF3145-721	SHROUD BRKT,PLATE,STEEL,1/8 THICK,2	404
CWTAYN031-100	SCREW, BUTTON HEAD, BLK XYLAN, 5/1	405
CWWALYN031-008	WASHER, SPLIT, 5/16 ID, BL	406
CWWBKN031-007	WASHER, FLAT, TYPE A, SAE, 5/16 ID	407
CWAC1177-101	FLOOR PROTECTOR, RUBBER, 4.563 X 4.	501
CWAC1178-101	FLOOR PROTECTOR, RUBBER, 2.563 X 6.	502

Your Price

